

PG-9037说明书 80g米黄色特种纸,双面折页 尺寸: 630x142mm



蓝牙手柄 产品说明书(PG-9037)中文版

适用说明:

- 1.非常感谢您购买ipega公司开发生产的蓝牙游戏手柄;
- 2.产品主要适用于在Android/iOS/Win 7/8/10系统上蓝牙连接时,进行游戏操作时使用!
- 3.适用设备:智能手机/平板电脑/智能电视机、机顶盒/PC电脑;
- 4.结构符合人体工程学,手感舒适!

*因官方游戏平台软件升级或源代码变更等不可抗拒的因素造成部分游戏无法与本产品连接操作,我公司不承担任何责任。对此我公司保留最终解释权。

售后客服QQ群: 344494518
客服电话: 400-806-3006
在线时间: 周一至周五9:30-17:30



安卓游戏平台下载二维码



艾派格官方微信公众
(扫码看教程)

功能按键图示:



操作使用模式:

Android 系统			
	HID模式(GamePad)	键盘模式	鼠标模式
模式配对 (长按2秒)	X+Home	A+Home	HID模式下按 Y+Home
指示灯	LED1	LED2	LED1或LED2
备注	在HID或键盘模式下均可动态切换成鼠标模式		

iOS 系统		Windows 系统	
	iCade 模式	X_Keyboard模式	HID模式(GamePad)
模式配对 (长按2秒)	B+Home	Y+Home	X+Home
指示灯	LED3	LED4	LED1
备注	默认为键盘英文输入法	支持iOS非越狱设备	无蓝牙功能PC设备 需蓝牙3.0以上适配器

电性参数:

- 1.工作电压: DC3.7V
- 2.工作电流: 30 mA
- 3.持续使用时间: 10H
- 4.静态电流: <35uA
- 5.充电电压/电流: DC5V/500mA
- 6.蓝牙传输距离: <=8M
- 7.电池容量: 300mAh
- 8.待机时间: 满电放置30天

安卓设备使用说明:

安卓系统绝大多数游戏支持HID模式(当在PC电脑上使用时,与安卓使用方法一样;在相关手机游戏厅或模拟器下载的游戏同样支持,如“葡萄游戏厅”)

- 1.同时按住X键和HOME键2秒,此时LED1指示灯快闪;图1
- 2.将Android设备的蓝牙功能打开,点击“扫描”
- 3.当搜索到蓝牙名为“PG-9037”的设备名时,选择配对连接;图2
- 4.连接成功,LED1指示灯常亮;图3
- 5.进入游戏(游戏厅或模拟器)下载的游戏可以直接玩!
- 6.推荐游戏:

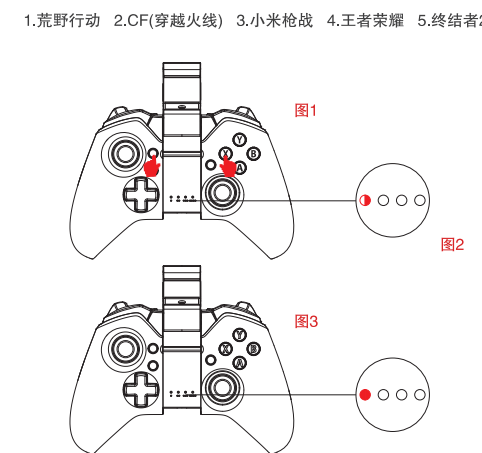

iOS设备X_Keyboard模式

X_Keyboard模式支持iOS非越狱设备,支持第三方购买的游戏平台在相关手机游戏厅或模拟器下载的游戏同样支持(关注艾派格官方微信公众号下载艾派格游戏大厅,购买第三方激活码,激活游戏大厅,仅限中国大陆地区)

- 1.同时按Y键和HOME键2秒,此时LED4指示灯快闪;图1
- 2.将iOS设备的蓝牙功能打开,当搜索到蓝牙名为“Newgamepad N1”的设备名时,选择配对连接;图2
- 3.连接成功,LED4指示灯常亮;图3
- 4.手机扫描二维码下载游戏平台,进入平台下载所需要的游戏。

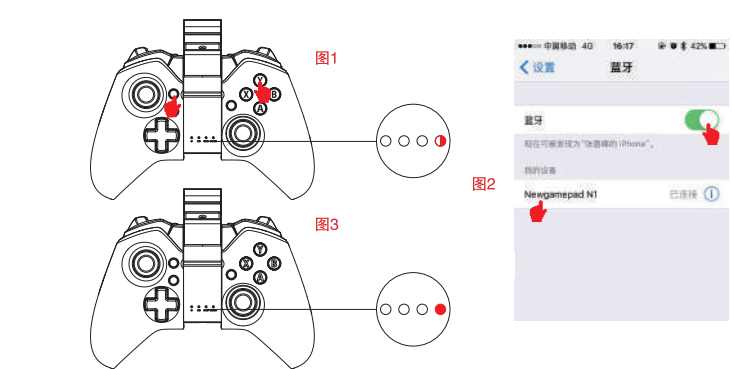

iOS按键映射功能:

- 1.支持iOS第三方游戏平台,如需要更改按键功能,在游戏厅内操作手柄即可更改;
- 2.艾派格游戏大厅映射方法:同时按下START+SELECT组合按键调出映射菜单;
- 3.将需要映射的按键,拖到相应的触摸功能键上与之重叠保存后即可操作游戏!

手柄充电/休眠/唤醒:

- 1.充电时侧面LED指示灯常亮,充电后熄灭!
- 2.睡眠/唤醒功能:游戏手柄在5分钟内不使用会进入休眠状态,当需要重新使用时需按HOME键唤醒即可回连;
- 3.电池电量不足时侧面LED指示灯快闪提示;

有线连接PC设备的操作方法:

- 1.用USB数据线将手柄和PC设备的USB接口相连,WIN7以上系统默认连接OK后,指示灯常亮,表示为X-INPUT的操作模式;
- 2.X-INPUT有线模式下支持绝大多数PC版的经典大型游戏的操作!如:极品飞车

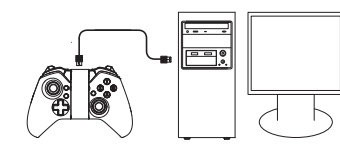

蓝牙连接PC设备操作方法

- 1.关机状态下,同时按住手柄HOME+X键搜索蓝牙设备;
- 2.将蓝牙4.0接收器插入PC设备的USB接口,Windows系统会自动安装驱动程序;
- 2.1驱动程序安装成功后,会在电脑的右下角显示蓝牙设备的符号;如下图1:
- 2.2将鼠标移动到蓝牙符号处,单击鼠标右键,选择“添加设备”;如下图2:
- 2.3选择“添加设备”后,会在对话框内搜索到设备的型号(PG-9037)图标;如下图3:
- 2.4点击“下一步”,并选择“不使用代码进行配对”,确认后则会自动添加,提示蓝牙连接成功!连接OK后,指示灯常亮!如下图4:
- 2.5蓝牙连接成功后为D_INPUT模式;在D_INPUT模式下,支持以模拟器方式运行的游戏!



注意事项:

- 1.请不要把本产品放在潮湿或高温地方存储;
- 2.不要敲击、摔打、棒打、刺穿、或试图去分解本产品,以免对产品造成不必要的损害;
- 3.产品内置电池,请勿和垃圾一起丢弃;
- 4.不要在靠近火或其它热源的地方对手柄进行充电。
- 5.非专业人员请勿拆卸本产品,否则不在售后保修服务内;

配件清单:

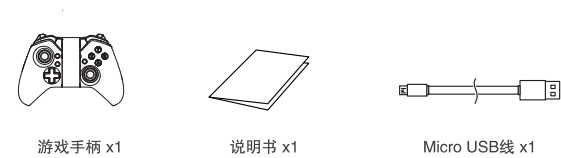

Ipega与ePega商标同属于PEGA LIMITED所有。
专利号: ZL2014302714740

正面

反面



Bluetooth Gamepad Instruction Manual(PG-9037)

Applicable instructions

- 1.Thanks for purchasing iPega developed Bluetooth Gamepad.
- 2.This Gamepad support playing games on Bluetooth enabled Android 3.2v+ tablet / smart phone / TV box / smart TV, iOS7+ mobile phone / tablet , Win7 / Win8 / Win10 PC without any drivers.
- 3.Ergonomic streamlining and comfortable hand hold feelings.

* Due to the official game platform software upgrades or source code changes and other not resist factors caused some of the game can not be played or connected with our Gamepad, iPega company has no responsibility,iPega reserve the right of final interpretation for this.

Introduction for key functions:

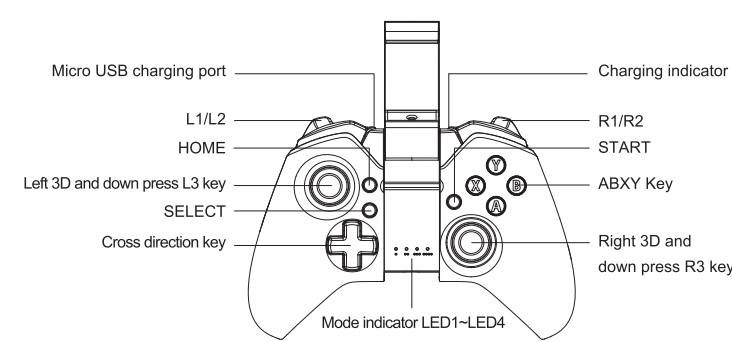

Electrical Parameters:

- 1.Working voltage: DC3.7V
- 2.Working current: 30 mA
- 3.Continuous gameplay time: 10H
- 4.Static current: <35uA
- 5.Charging voltage/current: DC5V/500mA
- 6.Bluetooth transmission distance: <=8M
- 7.Battery capacity: 300mAh
- 8.Standby time: up to 30days once fully charged

Charge/ Sleep/ Wake up function of Gamepad:

- 1.Charging indicator will lit on while charging and will turn off after fully charged.
- 2.Sleep/Wake up function: Gamepad will enter into sleeping mode if not in use for 5 minute, and press HOME button for wake up and reconnect automatically.
- 3.Charging LED flashing quickly for low battery remind.

Operation Instructions:

Android system			
	HID Mode(GamePad)	Keyboard Mode	Mouse Mode
Bluetooth pairing buttons (Press and hold on 2's)	X+Home	A+Home	Press Y+Home button to switch from HID mode to mouse mode
Indicator	LED1	LED2	LED1 or LED2
Remark	Freely dynamic swift to mouse mode from HID or keyboard mode		

iOS system		Windows system	
	iCade Mode	HID Mode (GamePad)	
Bluetooth pairing buttons (Press and hold on 2's)	B+Home	X+Home	
Indicator	LED3	LED1	
Remark	Default English keyboard input	No Bluetooth function PC, need buy a Bluetooth Dongle	

Android Game Center



Scan to download Android Game Center
Android system users only

Usage of Android device

It supports the vast majority of games, such as: Shadowgun/Modern Warfare 5/Asphalt/Contra/metal Slug, and emulator games (such as MC4, Wild blood, Dungeon Hunter, Zombie, FC emulator, GBA emulator, arcade emulator, SFC emulator, N64 emulator, Shadowgun, sonic CD, Cordy, Soulcraft, zenonia4, 9 Innings 2013,Riptide GP, etc.). Or you can scan QR code to download Android Game Center and download games from Android Game Center for playing.

- 1.Press and hold X button + HOME button for 2's, then release two buttons until LED1 flash quickly, Pic1
- 2.Open the Bluetooth on Android device, click searching.
- 3.Find and select "PG-9037" for Bluetooth pairing, Pic2
4. LED1 lit on after Bluetooth connected, Pic3
- 5.Support kinds of games which download from Google Play Store, such as:
Implosion / Dead Trigger / Dead Effect / CS Portable / The dungeon hunter 4 glory palace / SHADOWGUN: DeadZone / Sou/Craft - Action RPG

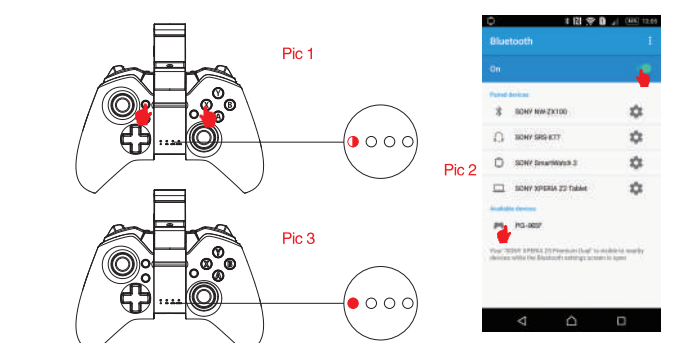

Usage of iOS devices

Support iOS non jail-breaking devices. Could play games which download from Apple APP Store. Searching "iCade" from APP Store will come out vast of iCade games for playing. (Support parts of games under iCade mode as game device is limited for iOS system.)

- 1.Firstly, you need to set keyboard input in English, Pic1
- 2.Press and hold B button + HOME button for 2's, then release two buttons until the LED3 flash quickly, Pic2
- 3.Open the Bluetooth on iOS device, click searching.
- 4.Find and select "PG-9037" for Bluetooth pairing, Pic3
5. LED3 lit on after Bluetooth connected, Pic4

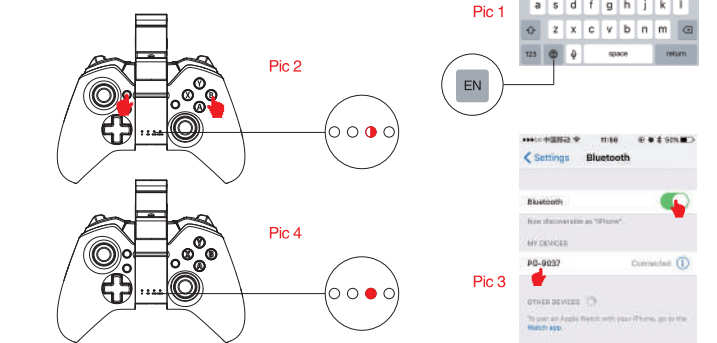

Support parts of games under iCade mode:

- Akane the Kunoichi Lite-haruneko
- Temple Run-Imangi Studios, LLC
- Rush city-Acceleroto
- Iron Frost-YOMEN, inc.
- Recess Riot-Deceased Pixel LLC
- Super Mega Worm Lite - Deceased Pixel LLC
- Emerald Mine - Las Bird
- Guns n'Bottles - Ivanovich Games
- Danmaku Unlimited 2 lite - Bullet Hell Shump
- qub - Andrew Brinkhaus
- Alien Annihilation-Free retro - space shooter
- Heli Apps
- Bullet Hell Infinite - Nicolas Bevilard
- Retro Dust-Classic Arcade - Asteroids Vs Invaders
- RI Productions
- J-Werewolf LITE - Daniel Novais
- Recess Riot Lite - Deceased Pixel LLC
- Space Invasion FREE - merlyn lear
- Vector Star Brawl - Jorge Arroyo
- The Invaders - RI Productions
- Towerman - Tomek Szczepanski
- Bunny Leap - John Carlyle

How to connect PC device for playing games by using USB data cable:

- 1.USB cable is required to connect the USB port of the PC device with the Gamepad. When the WIN7 or above system is connected by default, the indicator light is on, and showing the operation mode of X-INPUT.
- 2.In X-INPUT wired mode, it can support the operation of vast majority of classic large-scale games in PC version.
Such as: Need for Speed

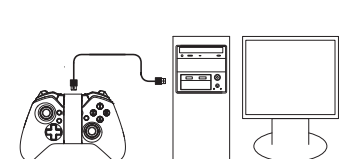

How to connect PC device with Bluetooth:

1. With the gamepad off, press and hold gamepad button HOME + X simultaneously for searching the Bluetooth device.
2. Insert Bluetooth 4.0 receiver into the USB interface on PC device; Windows system will automatically install the driver.
- 2.1 After the driver is installed successfully, the symbol of the Bluetooth device will be displayed in the lower right corner of the computer.
- 2.2 Move the mouse to the Bluetooth symbol, click the right mouse button and select "Add Device".
- 2.3 After selecting "Add Device", the icon of the model of the device (PG-9037) will be searched in the dialog box;
- 2.4 Click "Next" and select "Do not use the code to match", it will be automatically added after confirming, then remind the Bluetooth is connected successfully! After connecting OK, the indicator light is always on!
- 2.5 It will be D_INPUT mode after the Bluetooth is connected successfully, and can support the games running in simulator way.

Notes:

1. Please do not store this product in wet or high-temperature areas.
2. Don't knap, beat, drub, pierce, or try to decompose this product, to avoid unnecessary damage to the product.
3. The product has built-in batteries, and please don't discard them together with the garbages.
4. Don't charge the controller in a place near the fire or other heat source.
5. Non professional personnel should not disassemble the product, otherwise it will not be covered in the after-sales warranty service.

Accessories List

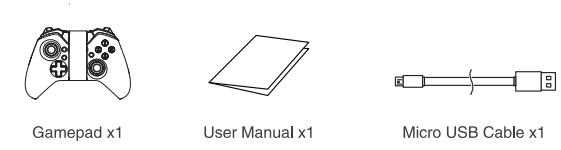

Ipega and ePega trademarks all belong to PEGA LIMITED.
Patent NO.: ZL2014302714740