

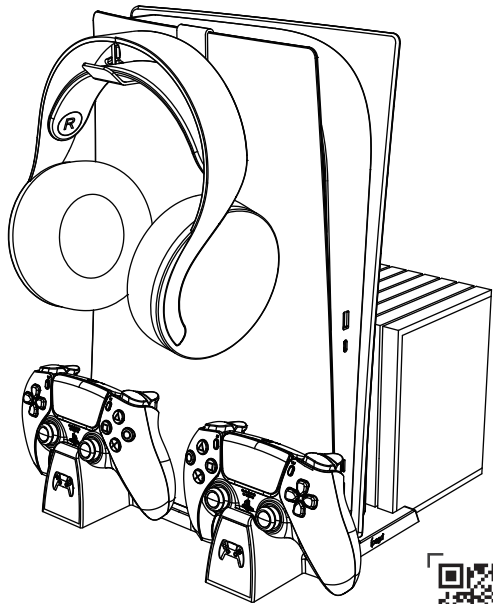

## 5合1主机支架

产品说明书 (PG-P5009)



售后客服QQ群: 837350687  
客服电话: (0755) 2791 8998  
在线时间: 周一至周五9:30-17:30



### 产品外观图示:

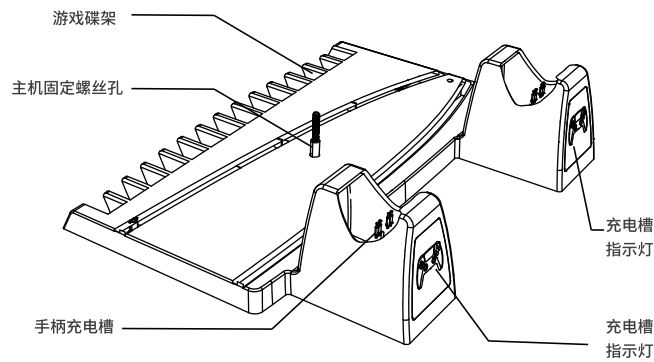

### 产品特征:

1. 本产品适用于给P5原装游戏手柄充电, 配件摆放等。
2. 带充电指示灯, 在充电过程中便于识别充电状态。
3. 配备专用的两个充电顶针位, 手柄充电时, 随取随放使用非常方便。
4. 产品内置直流升压稳压电路, 能持续提供5V稳压充电。
5. 配备游戏碟架, 可放置14个游戏碟。
6. 配备耳机支架, 可放置耳机, 方便拿取。

### 产品使用说明:

1. 将P5主机放本产品底座上, 并拧紧底座螺丝, 如图1。
2. 把底座上自带的USB线插头插入P5主机前边USB接口上, 此时充电槽显示白灯。
3. 分别将两个P5手柄的四个顶针接触位, 对准P5009座充上的顶针, 再放入手柄, 此时对应红灯长亮开始充电, 充满亮白灯。

4. USB母座, 5V输出, 可以给耳机, 手机等充电。

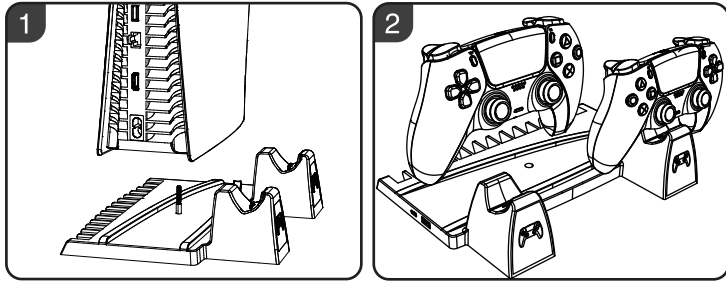

### 产品技术参数:

工作电压: DC 5.2V      充电时间: 约2.5-3H左右      充电电流: ≤800 mA(单个手柄)

### 注意事项:

1. 外接5V 其它电源可能会导致本产品工作异常。
2. 产品注意事项:
  - ①: 使用本产品时必须使用P5原装主机提供电源。
  - ②: 当PS5手柄充电电量达到约80%以上电量时, 如果这时候去拔掉手柄再插入充电, 会因手柄有电池保护功能, 手柄可能会不充电; 需等手柄电池电量低于80%以下电量才会继续充电。
  - ③ 当本产品给两个P5手柄充电时, 不建议同时使用底座上的扩展USB供电给其他设备。
3. 本产品在长期不使用时, 应将电源USB插头从P5主机上取出。
4. 本产品在使用或存放时, 应尽量避免开灰尘、重压, 以免影响使用寿命。
5. 本产品因使用不当而造成浸水、撞坏或摔坏, 出现电气性能问题, 请停止使用。
6. 本产品不能在潮湿的环境里使用、存放。
7. 如有损坏请及时送维修部门处理, 切勿自行拆卸。

### 产品清单:

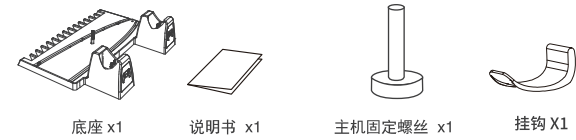

专利号: ZL202130207048.0



## P5009 Charge Dock

User Guide(PG-P5009)

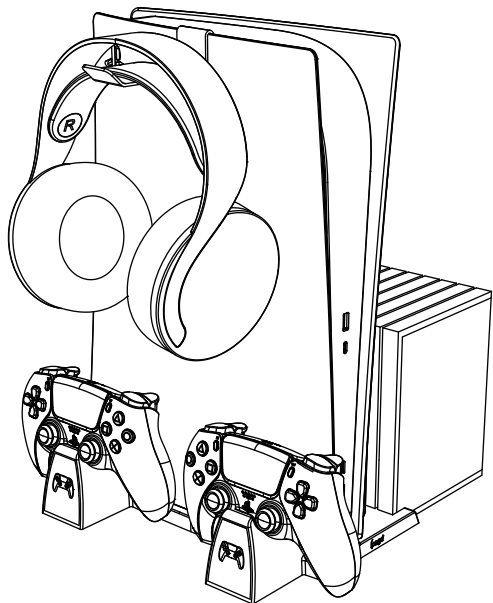

### Illustration:

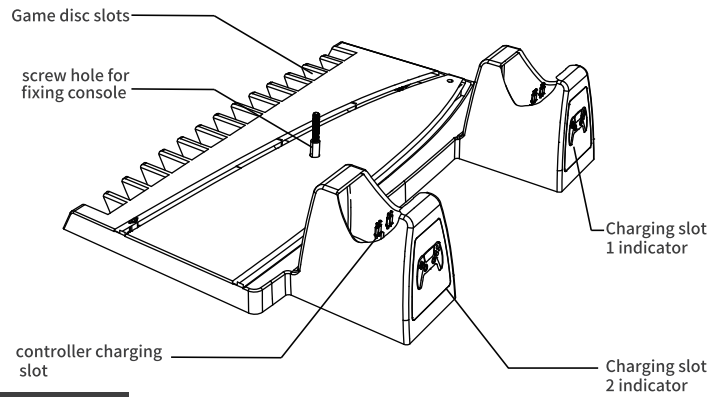

### Features:

1. This product is a multi-functional Stand for P5 console and accessories. Which can be as a vertical stand for P5 console, charge station for P5 controllers, a headset holder, 14pcs game disc storage for the console.
2. With charging indicator, it is easy to identify the charging status during charging.
3. It is equipped with two charging positions for original P5 game controller charging, and it is easy to operation.
4. Built-in stable circuit, continuous supply 5V power for charging.
5. Equipped with game disc slots, 14 game discs can be placed.
6. Equipped with headsets bracket, the headsets can be placed for easy access and storage.

### Product instructions:

1. Put the P5 console on the base of the product, and tighten the screws, as shown in Pic 1.
2. Put the P5 console on the P5009 stand, and connect to the P5 console by using the USB connector, the white light will turn on at this time.
3. Connect the controller to the charge dock by aligning the "EXT" port at the bottom of the controller with the contacts on the charge dock, then the red light will turn on to start charging, and the white light will turn on when fully charged.

4. With a USB female port, providing 5V output, which can be used to power headphones and mobile phones.

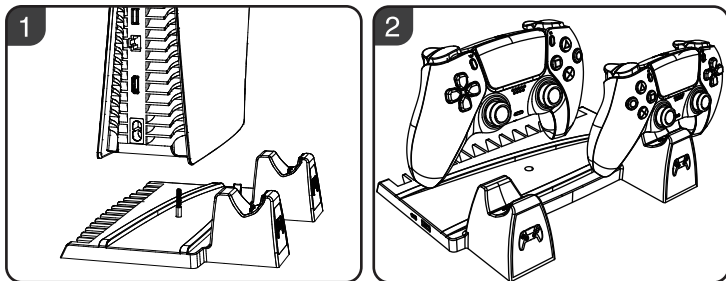

### Parameters:

Working voltage: DC 5.2V      Charging time: Approx. 2.5-3H  
charging current: ≤ 800 mA (single Gamepad).

### Notes:

1. Connect other 5V power source may cause the product working abnormal
2. Note:
  - ①: P5 console must be used to provide power when using this product.
  - ②: When the power level of the P5 controller reaches about 80% or more, if you unplug the controller and re-plug it in, at this time, the controller may not be charged due to the battery protection of the controller; you need to use it until the battery power level of the controller is below 80%.
  - ③: When this product is charging two P5 controllers, it is not recommended to use the USB on the base to supply power to other devices at the same time.
3. When the product is fully charged or not in use, please unplug the USB port from P5 console.
4. When this product is used or stored, dust and heavy pressure should be avoided, so as not to affect the service life.

5. Please stop using it if it is immersed in water, crashed or broken due to improper use.
6. This product cannot be used or stored in a humid environment.
7. If there is any damage, please send it to the maintenance department for disposal, and do not disassemble it by yourself.

### Product note:

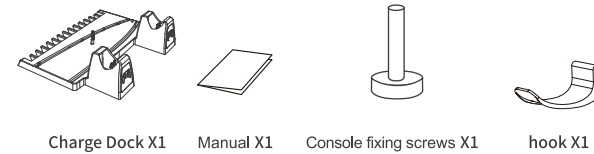

Patent NO. : ZL202130207048.0