



## 数显充电电池包

产品说明书 (PG-P5042)

### 产品特点:

- 1.本产品适用于普通版及精英版P5手柄;
- 2.配备LED显示屏, 实时显示电池电量;
- 3.内置大容量可充电电池, 持久续航;
- 4.即插即用, 操作简单;
- 5.带过充过流保护及高温自动断电保护, 安全可靠;

### 产品图示:

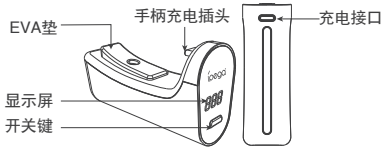

### 产品特性参数:

输入电压: DC5V  
输入电流:  $\leq 1.2A$   
充电时间: 约3小时  
续航时间: 4~8小时  
电池容量: 2000mAh

### 产品使用说明:

给P5手柄充电:

- 1.普通版P5手柄直接将电池包插入手柄即可。精英版P5手柄需先将附带的增厚垫放入电池包上再装配至手柄。

普通版P5手柄装配方法

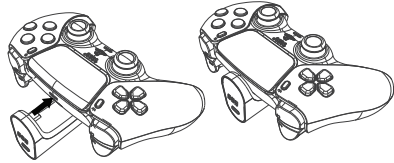

精英版P5手柄装配方法  
EVA棉垫

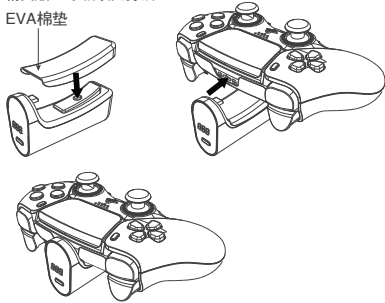

- 2.P5手柄与电池包装配好后, 短按按键显示屏将显示电池包当前电量并开始给手柄充电, P5手柄亮橙色呼吸灯。电量显示30秒后将自动熄灭;
- 3.电池包在给手柄充电的过程中, 如需查看电池包电量, 可按一下开关键, 显示屏将显示电池包当前电量; 长按开关键2秒可强制停止充电。
- 4.当P5手柄充满后, 电池包将自动停止给手柄充电。当电池包的电量降至0%时, 显示屏将显示当前电量0%, 30秒后熄灭, 电池包停止给手柄充电。

给电池包充电:

用附带的USB充电线, 一端插入电池包底部的Type-C端口另一端连接至P5主机的USB端口, 连接成功后, LED显示屏将闪烁并显示电池包当前电量, 当电池包充满后, 电量显示为100, 显示屏停止闪烁并熄灭。此时如需查看电池包电量, 需先拔掉充电线,再按一下开关键;

Type-C充电端口

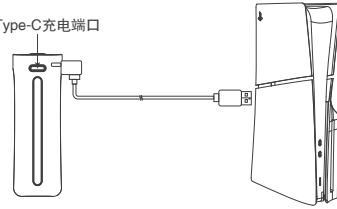

给电池包+手柄充电:

用附带的USB充电线, 一端插入电池包底部的Type-C端口另一端连接至P5主机的USB端口, 连接成功后, LED显示屏将闪烁并显示电池包当前电量。此时将优先给P5手柄, 当P5手柄充满后才给电池包充电, 当电池充满后, 电量将显示为100, 显示屏停止闪烁并熄灭。此时如需查看电池包电量, 需先拔掉充电线, 再按一下开关键;

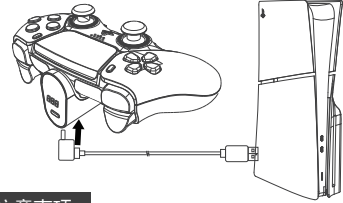

### 注意事项:

- 1.如长期闲置未使用, 需每三个月给电池包充一次电;
- 2.如超过六个月未使用且未给电池包进行充电有可能造成电池深度自放电而无法再充电使用;
- 3.请勿拆解或长时间短路电池包输出端, 以免造成不可逆永久损坏。
- 4.请不要把本产品在潮湿或高温地方存储。
- 5.请勿敲击、摔打、刺穿、或试图去分解本产品, 以免对产品造成不必要的损害。
6. 请勿拆卸本产品, 否则不在售后保修服务内。
- 7.产品内有电芯和电容等电子材料, 不可随便丢弃, 须集中给有资质的回收机构。
8. 因不可抗拒的因素造成部分产品无法连接操作, 我公司不负任何责任, 对此我公司保留最终解释权;

### 产品清单:

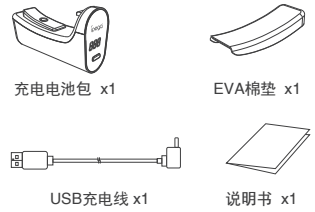

## Battery Pack With LED Display

User Manual (PG-P5042)

### Product Description:

1. Compatible with both the P5 controller & Edge controller
2. Equipped with an LED display that shows real-time battery levels.
3. Built-in high-capacity rechargeable battery for long-lasting performance.
4. Plug-and-play design for easy operation.
5. Includes overcharge and overcurrent protection, as well as automatic shutdown protection at high temperatures, ensuring safety and reliability.

### Function Keys:

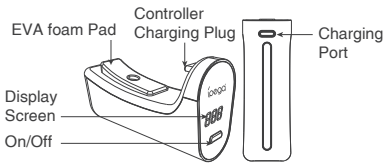

### Specifications:

Input Voltage: DC 5V  
Input Current:  $<1.2A$   
Charging Time: Approximately 3 hours  
Battery Life: 4-8 hours  
Battery Capacity: 2000mAh

### Product instructions:

**Charging the P5 Controller:**

1. Install the battery to the XBX/XBS original controller. Once assembled, you can start using it. Simply press the power button on the LED display to see the current available battery level.
- The LED display will automatically turn off after 30 seconds.

Assembly Method for P5 Controller

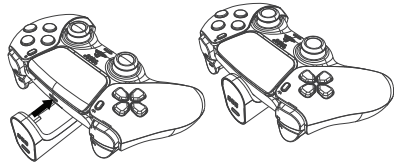

Assembly Method for Edge Controller

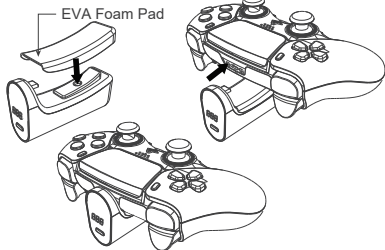

2. Charging Process: Once the P5 controller and battery pack are assembled, short press the on/off button. The display screen will show the current battery level of the pack and begin charging the controller. The P5 controller will display an orange breathing light. The battery level will automatically turn off after 30 seconds.
3. Checking Battery Level: During charging, if you want to check the battery level, press the on/off button once. The display screen will show the current battery level. To forcibly stop charging, press and hold the power button for 2 seconds.
4. Automatic Stop: Once the P5 controller is fully charged, the battery pack will automatically stop charging the controller. If the battery pack's charge drops to 0%, the display will show 0%, and after 30 seconds, it will turn off, stopping the charge to the controller.

**Charging the Battery Pack:**

Using the Included USB Charging Cable

- Plug one end into the Type-C port at the bottom of the battery pack.
- Connect the other end to the USB port of the P5 console.
- Once connected, the LED display will start flashing and show the current battery level of the pack.
- When the battery pack is fully charged, the display will show 100, the screen will stop flashing, and then turn off.
- To check the battery level after charging, unplug the charging cable and press the on/off button once.

Type-C Charging Port

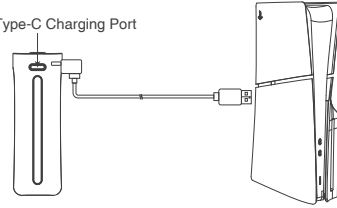

**Charging the Battery Pack and Controller:**

- Use the included USB charging cable as described above.
- Once connected, the LED display will flash and show the current battery level of the pack.
- The P5 controller will be charged first. After the controller is fully charged, the battery pack will begin charging.

- When the battery pack is fully charged, the display will show 100, the screen will stop flashing, and then turn off.
- To check the battery level after charging, unplug the charging cable and press the on/off button once.

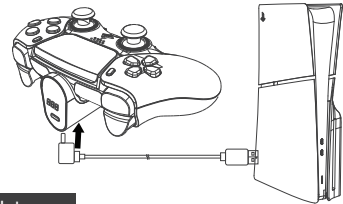

### Note:

- 1.If the battery pack is not used for an extended period, it should be charged every three months.
- 2.If the battery pack remains unused and uncharged for more than six months, it may experience deep self-discharge, making it impossible to recharge.
- 3.Do not disassemble or short-circuit the output end of the battery pack for extended periods, as this may cause irreversible permanent damage.
4. Please do not store this product in damp or high-temperature areas.
5. Avoid hitting, dropping, piercing, or attempting to disassemble the product to prevent unnecessary damage.

6. Non-professionals should not disassemble the product, as it will void the warranty.
7. The product contains electronic components such as batteries and capacitors and should not be disposed of casually. Please dispose of them properly by giving them to qualified recycling facilities.
8. If certain products cannot connect or operate due to uncontrollable factors, our company does not assume any responsibility. We reserve the right to provide the final interpretation in such cases.

### Product List:

